

PRESSURE TRANSDUCERS

PWF-PB Flush Diaphragm type Pressure Transducer

1~50MPa

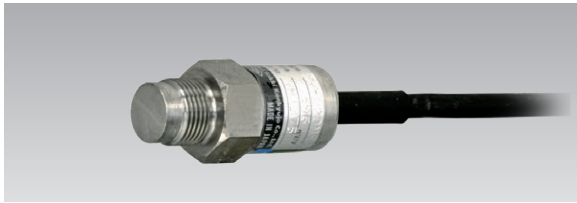

G3/8 size
High response

Because this transducer has its pressure-receiving surface at the top of mounting screws, it is suitable for use in a situation where pressure changes dynamically. It is widely used to measure the pressure in pipelines, cylinder pressure, and so forth
Protection ratings: IP67 equivalent

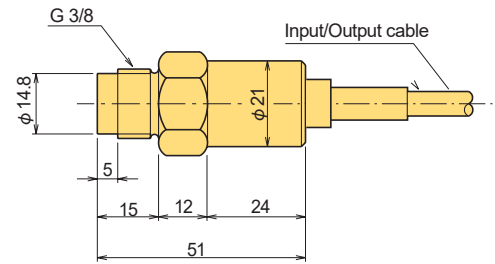
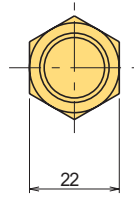

■ SPECIFICATIONS

TYPE	PWF-1MPB	PWF-2MPB	PWF-5MPB	PWF-10MPB	PWF-20MPB	PWF-50MPB
Capacity	1MPa	2MPa	5MPa	10MPa	20MPa	50MPa
Rated Output	1.75mV/V(3500×10 ⁻⁶ strain) ±25%					
Non-linearity	0.5%RO					
Hysteresis	0.5%RO					
Repeatability	0.5%RO					
Temperature effect on zero	0.06%RO/°C					
Temperature effect on span	0.03%/°C					
Compensated temperature range	-10 ~ +60°C					
Allowable temperature range	-20 ~ +70°C					
Over load	150%					
Ultimate overload rating	300%					
Input/Output resistance	350Ω					
Recommended exciting voltage	6V or less					
Allowable exciting voltage	10V					
Natural frequency	30kHz	40kHz	60kHz	80kHz	110kHz	170kHz
Mounting thread	G3/8 (PF3/8)					
Materials of pressure media	SUS630					
Weight	100g					

Input/Output cable :
φ 6mm 0.35mm² 4-core shielded chloroprene cable 2m

Applicable fitting torque: 10~20N·m

PWFC-PB Flush Diaphragm type Pressure Transducer

2~50MPa



G1/8 size
High response

The PWFC-PB flush diaphragm pressure transducer is small in size and the screw used to mount it is also small G1/8 (PF1/8). The high responsiveness to changes in pressure makes this transducer most suitable for pressure control systems or pressure measurement in a confined space. It is widely used to control pressure in production lines, to measure cylinder pressure, and for many other applications.

Protection ratings: IP67 equivalent

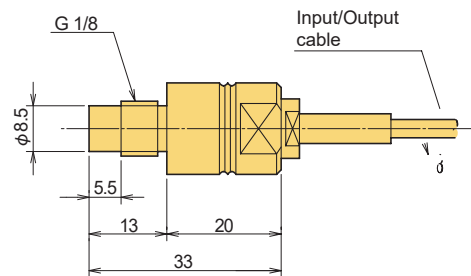
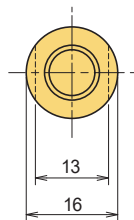

■ SPECIFICATIONS

TYPE	PWFC-2MPB	PWFC-5MPB	PWFC-10MPB	PWFC-20MPB	PWFC-50MPB
Capacity	2MPa	5MPa	10MPa	20MPa	50MPa
Rated Output	1.5mV/V(3000×10 ⁻⁶ strain) ±25%		2mV/V(4000×10 ⁻⁶ strain) ±25%		
Non-linearity	0.5%RO				
Hysteresis	0.5%RO				
Repeatability	0.5%RO				
Temperature effect on zero	0.03%RO/°C				
Temperature effect on span	0.03%/°C				
Compensated temperature range	-10 ~ +60°C				
Allowable temperature range	-20 ~ +70°C				
Over load	150%				
Ultimate overload rating	300%				
Input/Output resistance	350Ω				
Recommended exciting voltage	3V or less				
Allowable exciting voltage	6V				
Natural frequency	70kHz	90kHz	130kHz	180kHz	290kHz
Mounting thread	G1/8 (PF1/8)				
Materials of pressure media	SUS630				
Weight	25g				

Input/Output cable :
φ 3mm 0.05mm² 4-core shielded chloroprene cable 2m

Applicable fitting torque: 10~15N·m