

# PTASP6-F

## ALUMINIUM SINGLE POINT

- Fully sealed
- C3 accuracy class
- Anodised for protection
- For larger platform scales

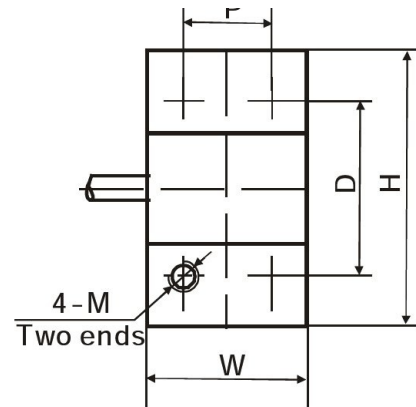
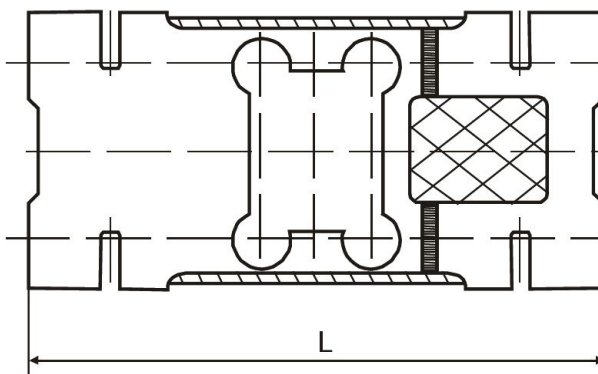
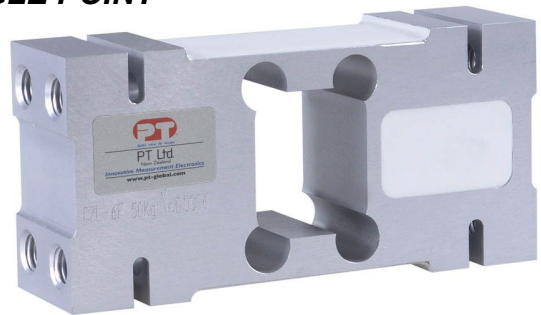

### Models

Capacity	Order	Platform	L	W	H	D	P	M	Weight (kg)
50kg	SPM0050A06FXXX	600x600mm	156(6.14)	44(1.73)	75(2.95)	50(1.97)	24(0.94)	M12	1.2
100kg	SPM0100A06FXXX	600x600mm	156(6.14)	44(1.73)	75(2.95)	50(1.97)	24(0.94)	M12	1.2
150kg	SPM0150A06FXXX	600x600mm	156(6.14)	44(1.73)	75(2.95)	50(1.97)	24(0.94)	M12	1.2
200kg	SPM0200A06FXXX	600x600mm	156(6.14)	44(1.73)	75(2.95)	50(1.97)	24(0.94)	M12	1.2
250kg	SPM0250A06FXXX	600x800mm	146(5.75)	60(2.36)	95(3.74)	70(2.76)	36(1.42)	M12	1.8
500kg	SPM0500A06FXXX	600x800mm	146(5.75)	60(2.36)	95(3.74)	70(2.76)	36(1.42)	M12	1.8
750kg	SPM0750A06FXXX	1200x1200mm	176(6.93)	76(2.99)	125(4.92)	95(3.74)	46(1.81)	M16	3.65
1000kg	SPM1000A06FXXX	1200x1200mm	176(6.93)	76(2.99)	125(4.92)	95(3.74)	46(1.81)	M16	3.65
2000kg	SPM2000A06FXXX	1200x1200mm	176(6.93)	76(2.99)	125(4.92)	95(3.74)	46(1.81)	M16	3.65

NOTE: dimensions are in mm(in.).

### Specifications

Signal Output at Capacity.....	<2±0.2 mV/V	Service Load.....	100% Capacity
Linearity Error.....	< 0.017% FSO	Safe Load.....	150% Capacity
Non-Repeatability.....	< 0.010% FSO	Ultimate Load.....	300% Capacity
Combined Error.....	< 0.020% FSO	Input Resistance.....	409Ω ± 6Ω
Off Centre Load Error.....	< 0.020% FSO	Output Resistance.....	350Ω ± 6Ω
Creep/(30 mins.).....	< 0.020% FSO	Insulation Resistance.....	> 5000 MΩ (@50 VDC)
Zero Balance.....	< 2.0% Capacity	Excitation Voltage(Rec).....	5~12V AC/DC
Temperature Effect on Span(/10C).....	< 0.014% FSO	Excitation Voltage(Max.).....	18V AC/DC
Temperature Effect on Zero(/10C).....	< 0.017% FSO	Cable.....	3m long, Ø6.2 mm
Operating Temperature Range.....	-35 ~ +65 C	.....	6 core screened PVC
Compensated Temperature Range.....	-10 ~ +40 C	Material.....	Aluminium Alloy
Storage Temperature Range.....	-50 ~ 85 C	Sealing.....	IP65

### Wiring Connections

Excitation +ve.....	Red	Sense +ve.....	Brown	Signal +ve.....	Blue
Excitation -ve.....	Yellow	Sense -ve.....	Black	Signal -ve.....	White

R81030