

## Model ST

S-TYPE

50kg~20t

### APPLICATIONS

- Hybrid scales
- Materials testing
- Lever conversions
- Crane scales
- Hopper weighing



### FEATURES

- Compatible with International standard fixings
- Tension, compression & suspended load applications
- Huge capacity coverage
- 3 year warranty
- Electroless nickel plated tool steel to IP65
- ISO 9001 certified manufacturing facilities





# Model ST

S-TYPE

50kg~20t

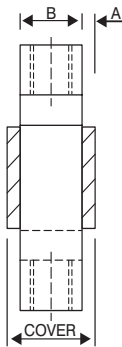
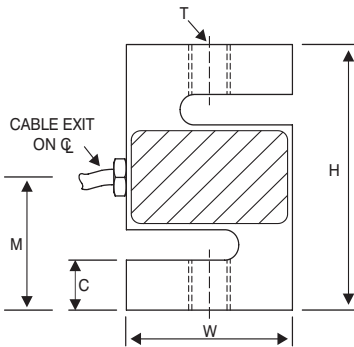

## Dimensions

Capacity	A	B	C	H	M	T	W
50kg	4	13	10.6	63.5	31.75	1/4" x 28P UNF	51
100kg	4	13	10.6	63.5	31.75	1/4" x 28P UNF	51
250kg	4	25	14.3	76	38	1/2" x 20P UNF	51
500kg	4	25	14.3	76	38	1/2" x 20P UNF	51
1000kg	4	25	14.3	76	38	1/2" x 20P UNF	51
2500kg	0	30	20.3	102	51	3/4" x 16P UNF	76
5000kg	0	30	20.3	102	51	3/4" x 16P UNF	76
10000kg	0	48	39.5	150	75	1 1/4" x 12P UNF	125
20000kg	0	58	40	160	80	1 1/4" x 12P UNF	158

## Ordering Information

Capacity	Model
50kg	ST-50
100kg	ST-100
250kg	ST-250
500kg	ST-500
1000kg	ST-1000
2500kg	ST-2500
5000kg	ST-5000
10000kg	ST-10000
20000kg	ST-20000

## Accessories

Part	50kg-100kg	250kg-1000kg	2500kg
Load Button	A-LB0.250	A-LB0.500	A-LB0.750
Load Socket	A-LS20	A-LS20	A-LS30
Rod End Bearings	A-RE0.250	A-RE0.500	A-RE0.750-2
Spherical Washers	A-SW8/20	A-SW12/23	A-SW20/40

Part	5000kg	10000kg	20000kg
Load Button	A-LB0.750	A-LB0.250	A-LB0.250
Load Socket	A-LS30	A-LS75	A-LS75
Rod End Bearings	A-RE0.750-5	A-RE1.250-10	A-RE1.250-20
Spherical Washers	A-SW20/40	A-SW32/60	A-SW32/60

## Cable Colour Code

Excitation +ve	<b>Red</b>
Sense +ve	<b>Brown</b>
Excitation -ve	<b>Black</b>
Sense -ve	<b>Blue</b>
Signal +ve	<b>Green</b>
Signal -ve	<b>White</b>

## Cable Length

50kg-1000kg	4 Core	3 Metres
2500kg-5000kg	6 Core	5 Metres
10000kg-20000kg	6 Core	5 Metres

### TENSION APPLICATIONS

ROD END  
Used singularly  
or in pairs

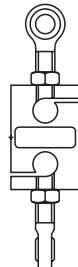

### COMPRESSION APPLICATIONS

LOAD SOCKET  
LOAD BUTTON  
ST LOADCELL

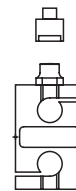

### SUSPENDED LOAD APPLICATIONS

SPHERICAL  
WASHER  
PAIR

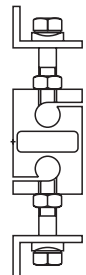

## Specifications

Nominal capacity	50kg to 20t	Compensated temp. range	-10° to 50° C
Nominal output at capacity	2mV/V ± 0.1%	Output resistance	352.2 Ohms
Factory calibration mode	Compression	Input resistance	410 Ohms nominal
Linearity error	0.017%	Service load	100% of Rated Capacity
Repeatability	0.01%	Safe load	150% of Rated Capacity
Zero return, creep (30 mins)	0.015%	Mechanical failure	> 300% of Rated Capacity
Temp. effect span/10° C	0.01%	Recommended excitation	5 Volts to 15 Volts AC or DC
Temp. effect zero/10° C	0.015%	Maximum excitation	15 Volts DC
Insulation resistance-brg. to gnd	> 5000 Mohms	Environmental protection	IP65 Standards
Insulation resistance-cbl. to gnd	> 1000 Mohms		

\*\* All specifications are a maximum, as a % (±) of full load, unless otherwise stated.



...better value by design!

# PT Ltd.

Innovative Measurement Electronics

### Sales & Product Information

P.O. Box 7205, Baulkham Hills, BC, NSW 2153, Australia

International	Fax +61 2 9680 7014	Phone +61 2 9680 7966
Australia	Fax 02 9680 7014	Phone 1800 777 866
New Zealand	Fax 0800 333 321	Phone 0800 543 210
Email	sales@pt-global.com	

<http://www.pt-global.com>

Due to our policy of continuous development, these specifications are subject to change without notice.



...a world of excellence!

