

尺寸及量程 / Size and Capacity

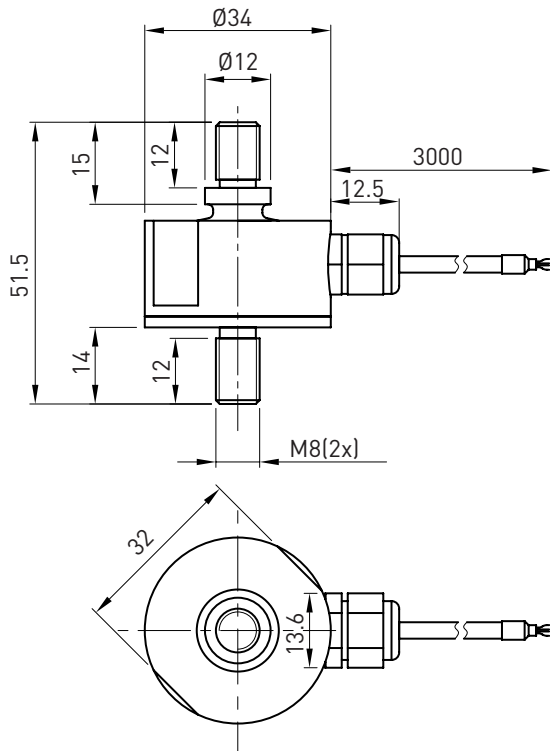

| 量程 / Capacity (kg) | 材料 / Material | 重量 / Weight |
|--------------------|-----------------------|-------------|
| 150/200/300/500 | 不锈钢 / Stainless steel | 0.25kg |

技术参数 / Technical Parameters

| 参数 | Specifications | 技术指标/Technique |
|-----------|-------------------------|---|
| 输出灵敏度 | Rated output | 1.5 ± 10% mV / V |
| 零点输出 | Zero balance | ± 2% F.S. |
| 非线性 | Non-linearity | 0.5% F.S. |
| 滞后 | Hysteresis | 0.5% F.S. |
| 重复性 | Repeatability | 0.5% F.S. |
| 蠕变 (30分钟) | Creep (30min) | 0.5% F.S. |
| 温度灵敏度漂移 | Temp. effect on output | 0.05% F.S. / 10°C |
| 零点温度漂移 | Temp. effect on zero | 0.05% F.S. / 10°C |
| 输入电阻 | Input impedance | 385 ± 10Ω |
| 输出电阻 | Output impedance | 350 ± 5Ω |
| 绝缘电阻 | Insulation | ≥2000MΩ/100VDC |
| 激励电压 | Recommended excitation | 5~10V |
| 最大激励电压 | Maximum excitation | 15V |
| 温度补偿范围 | Compensated temp. range | -10 ~ 60°C |
| 工作温度范围 | Operation temp. range | -20 ~ 80°C |
| 安全超载 | Safe overload | 120% F.S. |
| 极限超载 | Ultimate overload | 150% F.S. |
| 电缆线尺寸 | Cable size | Ø4 × 3000 mm |
| 防护等级 | Protection class | IP67 |
| 连接方式 | Cable color code | Input: Red(+) Black(-); Output: Green(+) White(-); 输入: 红 (+) 黑 (-); 输出: 绿 (+) 白 (-); |



特点和用途 / Features & Applications

- 不锈钢材料，拉压双向
- IP67, 防水、耐腐蚀
- 主要用于试验机、小型焦煤、料位计称，微型拉压力测力设备，如机械手，贴膜机、铆钉机、焊接机、插拔力测试仪
- Made of stainless steel
- IP67, waterproof, corrosion resistance
- Tension and compression application
- Mainly used for testing machine, miniature tension and pressure test equipment, such as lamination machine, riveting machine, welding machine

受力方式 / Load Direction

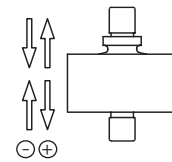

接线图 / Schematic Wiring Diagram

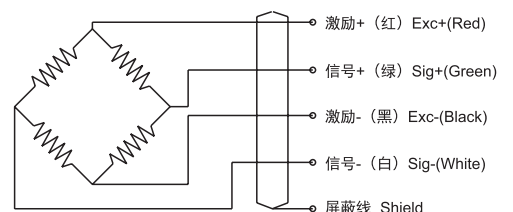

注：屏蔽线不与弹性体相连。

Note: Cable shield is not connected to element.